



Name	Easting	Northing	Height
STN2	549122.419	125669.690	61.034
STN3	549146.734	125674.211	59.254
STN4	549138.051	125667.020	59.686
STN5	549136.286	125665.252	59.799
STN6	549140.335	125674.211	59.253
STN7	549158.816	125662.461	61.787
STN8	549140.316	125665.482	59.198
STN9	549140.755	125663.235	59.301
STN10	549130.565	125665.431	60.168
STN11	549107.348	125625.873	63.217
STN12	549124.821	125624.738	61.037
STN13	549151.412	125660.486	58.716
STN14	549107.348	125625.873	63.217
STN15	549138.051	125667.020	59.686
STN16	549136.286	125665.252	59.799
STN17	549140.335	125674.211	59.253
STN18	549158.816	125662.461	61.787
STN19	549140.316	125665.482	59.198
STN20	549140.755	125663.235	59.301
STN21	549130.565	125665.431	60.168
STN22	549107.348	125625.873	63.217
STN23	549124.821	125624.738	61.037
STN24	549151.412	125660.486	58.716
STN25	549107.348	125625.873	63.217
STN26	549138.051	125667.020	59.686
STN27	549136.286	125665.252	59.799
STN28	549140.335	125674.211	59.253
STN29	549158.816	125662.461	61.787
STN30	549140.316	125665.482	59.198
STN31	549140.755	125663.235	59.301
STN32	549130.565	125665.431	60.168
STN33	549107.348	125625.873	63.217
STN34	549124.821	125624.738	61.037
STN35	549151.412	125660.486	58.716
STN36	549107.348	125625.873	63.217
STN37	549138.051	125667.020	59.686
STN38	549136.286	125665.252	59.799
STN39	549140.335	125674.211	59.253
STN40	549158.816	125662.461	61.787
STN41	549140.316	125665.482	59.198
STN42	549140.755	125663.235	59.301
STN43	549130.565	125665.431	60.168
STN44	549107.348	125625.873	63.217
STN45	549124.821	125624.738	61.037
STN46	549151.412	125660.486	58.716
STN47	549107.348	125625.873	63.217
STN48	549138.051	125667.020	59.686
STN49	549136.286	125665.252	59.799
STN50	549140.335	125674.211	59.253
STN51	549158.816	125662.461	61.787
STN52	549140.316	125665.482	59.198
STN53	549140.755	125663.235	59.301
STN54	549130.565	125665.431	60.168
STN55	549107.348	125625.873	63.217
STN56	549124.821	125624.738	61.037
STN57	549151.412	125660.486	58.716
STN58	549107.348	125625.873	63.217
STN59	549138.051	125667.020	59.686
STN60	549136.286	125665.252	59.799
STN61	549140.335	125674.211	59.253
STN62	549158.816	125662.461	61.787
STN63	549140.316	125665.482	59.198
STN64	549140.755	125663.235	59.301
STN65	549130.565	125665.431	60.168
STN66	549107.348	125625.873	63.217
STN67	549124.821	125624.738	61.037
STN68	549151.412	125660.486	58.716
STN69	549107.348	125625.873	63.217
STN70	549138.051	125667.020	59.686
STN71	549136.286	125665.252	59.799
STN72	549140.335	125674.211	59.253
STN73	549158.816	125662.461	61.787
STN74	549140.316	125665.482	59.198
STN75	549140.755	125663.235	59.301
STN76	549130.565	125665.431	60.168
STN77	549107.348	125625.873	63.217
STN78	549124.821	125624.738	61.037
STN79	549151.412	125660.486	58.716
STN80	549107.348	125625.873	63.217
STN81	549138.051	125667.020	59.686
STN82	549136.286	125665.252	59.799
STN83	549140.335	125674.211	59.253
STN84	549158.816	125662.461	61.787
STN85	549140.316	125665.482	59.198
STN86	549140.755	125663.235	59.301
STN87	549130.565	125665.431	60.168
STN88	549107.348	125625.873	63.217
STN89	549124.821	125624.738	61.037
STN90	549151.412	125660.486	58.716
STN91	549107.348	125625.873	63.217
STN92	549138.051	125667.020	59.686
STN93	549136.286	125665.252	59.799
STN94	549140.335	125674.211	59.253
STN95	549158.816	125662.461	61.787
STN96	549140.316	125665.482	59.198
STN97	549140.755	125663.235	59.301
STN98	549130.565	125665.431	60.168
STN99	549107.348	125625.873	63.217
STN100	549124.821	125624.738	61.037

125700N

125675N

125650N

125625N

549100E

549125E

549150E

549175E

549200E

549200E

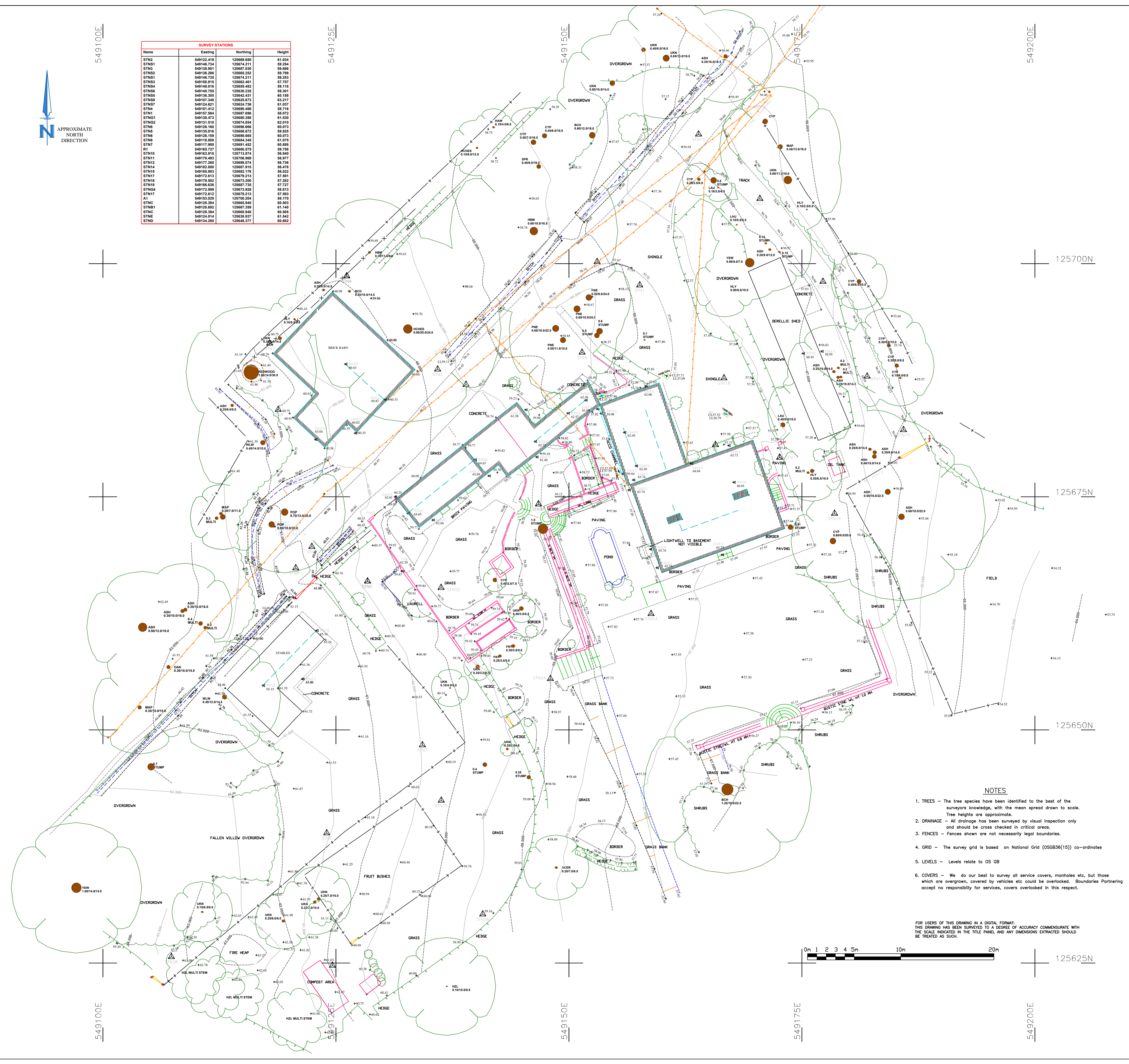

LEGEND

- EXTENT OF VEGETATION
- HEDGES
- BUSH
- Tree
0.4/8/12
(Dia) (Dia) (Metres)
- SINGLE GATE
- DOUBLE GATE
- OVERHEAD CABLE
- WALL
- BUILDING
- ORDNANCE SURVEY BENCH MARK OSBM Value 28.86
- BOLLARD B
- BOREHOLE BH
- BUS STOP BS
- BRITISH TELECOM BOX BT BOX
- BRITISH TELECOM MANHOLE BTMH
- CABLE TELEVISION MANHOLE CATV
- FIRE HYDRANT FH
- FENCE CBF H= 1.8M
- FOOTPATH FP
- GULLY G
- LAMP POST LP
- MANHOLE MH
- POST BOX PB
- ROAD SIGN RS
- STOP VALVE SV
- SURVEY STATION
- TELEPHONE CALL BOX TCB
- TRAFFIC LIGHT TL
- TELEGRAPH POLE TP
- SPOT LEVEL + 28.86
- COVER LEVEL CL 28.86
- INVERT LEVEL IL 28.86
- UNABLE TO LIFT UTL
- DITCH
- BANKING

TREE LEGEND

- | | | | | | | | | | | | | | | |
|--------|--------|--------------|---------|------|--------|---------------|---------|--------------|-----------------------|----------------|----------------|----------|--------|----------|
| ALDER | ASH | BEECH | CYPRESS | DEER | ELM | FRUIT | GUM | HAWTHORN | HOLLY | HORSE CHESTNUT | HORNBEAM | LABURNUM | LARCH | LAUREL |
| ALD | ASH | BCH | CYP | DEE | ELM | FRU | GUM | HAW | HOL | HCH | HOB | LBU | LAR | LRL |
| UME | LOCUST | LONDON PLANE | MAPLE | OAK | POPLAR | PHODODENDRONS | SAPLING | SILVER BIRCH | SMOOTH JAPANESE MAPLE | SPRUCE | SWEET CHESTNUT | SYCAMORE | WALNUT | WHITEBAM |
| LCS | LPN | MFL | MAK | PKR | POP | RDR | RWN | SAP | SJM | SFR | SCR | SYC | WNT | WBC |
| WILLOW | YEW | | | | | | | | | | | | | |

FENCE DESCRIPTIONS

- | | | | |
|---------------------|-----|----------------------|-----|
| BARBED WIRE FENCE | BWF | INTERWOVEN FENCE | IWF |
| CLOSE BOARD FENCE | CBF | OPEN BOARD FENCE | CBF |
| CONCRETE/IRON FENCE | CFI | POST AND CHAIN FENCE | PCF |
| CHESTNUT PALING | CFP | POST AND RAIL FENCE | PRF |
| IRON RAILINGS | IRF | POST AND WIRE FENCE | PWF |
| | | WIRE MESH FENCE | WMF |

Rev	Description	Dn	Chk	Date



Little Chelmsford
Coldharbour Lane
Punnett's Town
East Sussex
TN21 5DN
Tel 01435 830738
Fax 01435 830738
email: info@boundariespartnering.co.uk

Client
Sample

Project
Sample

Drawing
SURVEY

Scale @ A1 1 TO 200	Date 27.04.2017	Drawn by GSR	Checked
Job No.	Drg. No.	Rev	

- NOTES
- TREES - The tree species have been identified to the best of the surveyors knowledge, with the mean spread drawn to scale. Tree heights are approximate.
 - DRAINAGE - All drainage has been surveyed by visual inspection only and should be cross checked in critical areas.
 - FENCES - Fences shown are not necessarily legal boundaries.
 - GRID - The survey grid is based on National Grid (OSGB36(15)) co-ordinates
 - LEVELS - Levels relate to OS GB
 - COVERS - We do our best to survey all service covers, manholes etc, but those which are overgrown, covered by vehicles etc could be overlooked. Boundaries Partnering accept no responsibility for services, covers overlooked in this respect.

FOR USERS OF THIS DRAWING IN A DIGITAL FORMAT:
THIS DRAWING HAS BEEN SURVEYED TO A DEGREE OF ACCURACY COMMENSURATE WITH THE SCALE INDICATED IN THE TITLE PANEL AND ANY DIMENSIONS EXTRACTED SHOULD BE TREATED AS SUCH.

